

The Global Water Submersible Sump Pump range provides a dependable solution for pumping drainage water, stormwater and wastewater containing solids for commercial, building services and industrial applications.

Single phase units are fitted with float switches for fully automatic operation and have in-built overload protection. Both single and three phase units can handle water with temperatures up to 40 °C continuous duty and 60 °C intermittent duty.

The GPD Series are all-stainless steel construction, fitted with 5 m electric cables. Units have a semi-open impeller that will pass 10 mm solids - ideal for greywater or stormwater applications.

The GPV Series are heavy duty units constructed from cast iron and stainless steel for durability and corrosion resistance, with either single or three phase electric motor. A 10 m power cable comes as standard.

All GPV pumps are fitted with vortex or double-channel impellers to enable the handling of suspended solids up to 65 mm in diameter.

Larger flow rate units and hazardous area units rated for Class 1 Zone 2 are available on request.



### Technical data

Pump model	Power (kW)	Current (A)	Voltage (V)	Outlet (mm)	Ø Solids (mm)
GPD32-25	0.25	1.9	240	32	10
GPD32-55	0.55	3.6	240	32	10
GPV40-75	0.75	4.8	240	40	40
GPV40-110	1.1	6.9	240	40	40
GPV50-110	1.1	7.8	240	50	50
GPV50-111	1.1	6.9	240	50	50
GPV65-180	1.8	11.6	240	65	60
GPV50-180	1.8	4.1	415	50	40
GPV65-200	2.0	4.6	415	65	60
GPV80-220	2.2	6.5	415	80	65
GPV80-300	3.0	7.5	415	80	65

### Performance curve

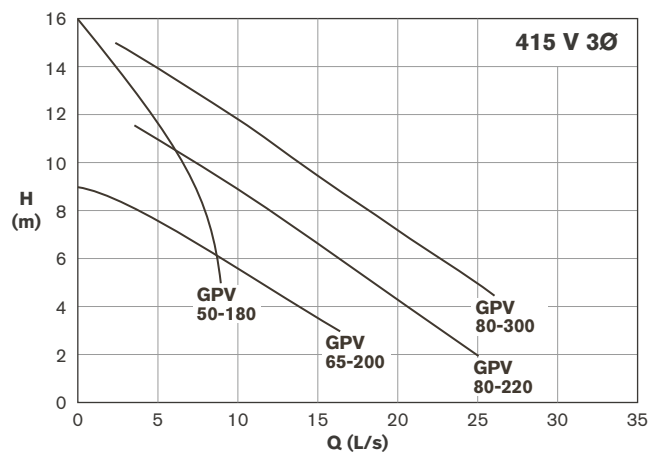
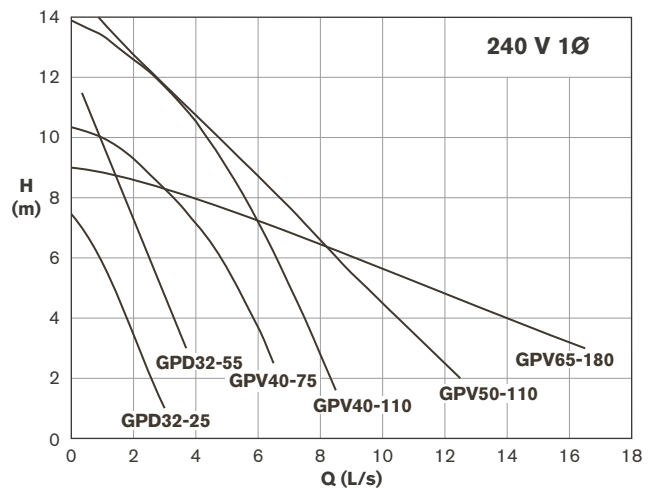

Suitable for small stormwater discharge and emptying small flooded areas (rooms, cellars, garages), for the disposal of domestic wastewater (i.e. dishwashers, washing machines) and emptying sludge chambers, sub-soil drainage pits and septic tanks.

### Features

- Constructed from corrosion resistant 304 stainless steel.
- Oil lubricated double mechanical shaft seal.
- Air-filled, continuous duty motors rated for up to 20 starts per hour.
- Built-in thermal protection with automatic reset.



### Dimensions (all measurements mm)

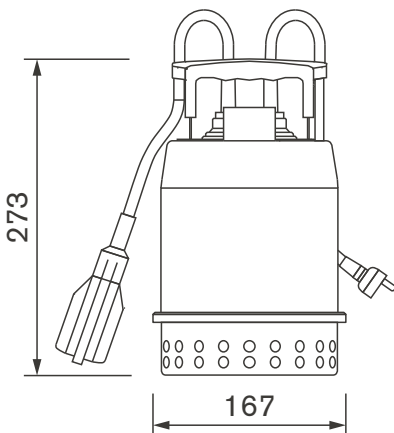

### Technical data

Outlet (mm)	32 BSP
Max flow rate (L/s)	2.5
Max head pressure (m)	7.0
Max liquid temp (°C)	50
Ø Solids (mm)	10
Power (kW)	0.25
Current (A)	1.9
Voltage (V)	240
Speed (RPM)	2900
Casing	Stainless steel
Impeller	PPE
Motor housing	Stainless steel
Protection	IP68
Cable details	5 m length, H05RN-F
Mounting	Free-standing only
Weight (kg)	4.4

### Performance curve

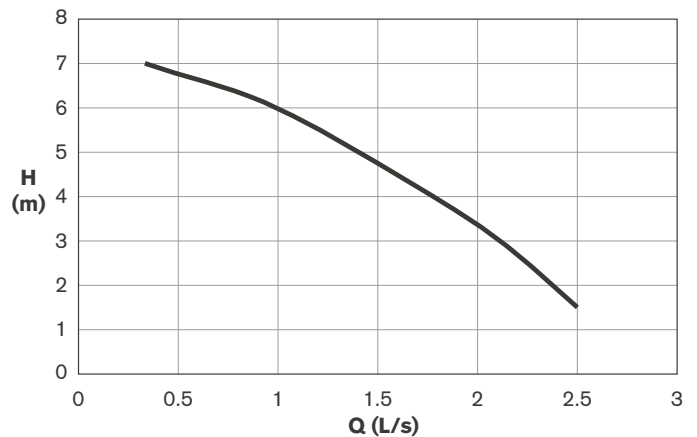

Suitable for small stormwater discharge and emptying small flooded areas (rooms, cellars, garages), for the disposal of domestic wastewater (i.e. dishwashers, washing machines) and emptying sludge chambers, sub-soil drainage pits and septic tanks.

#### Features

- Constructed from corrosion resistant 304 stainless steel.
- Oil lubricated double mechanical shaft seal.
- Air-filled, continuous duty motors rated for up to 20 starts per hour.
- Built-in thermal protection with automatic reset.



#### Dimensions (all measurements mm)

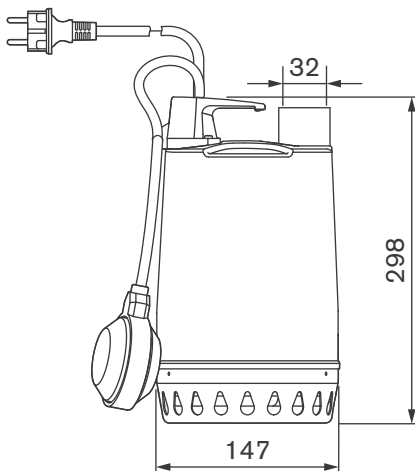

#### Technical data

Outlet (mm)	32 BSP
Max flow rate (L/s)	3.6
Max head (m)	11.5
Max liquid temp (°C)	50
Ø Solids (mm)	10
Power (kW)	0.55
Current (A)	3.6
Voltage (V)	240
Speed (RPM)	2900
Casing	Stainless steel
Impeller	Stainless steel
Motor housing	Stainless steel
Protection	IP68
Cable details	10 m length, H07RN-F
Mounting	Free-standing only
Weight (kg)	7.6

#### Performance curve

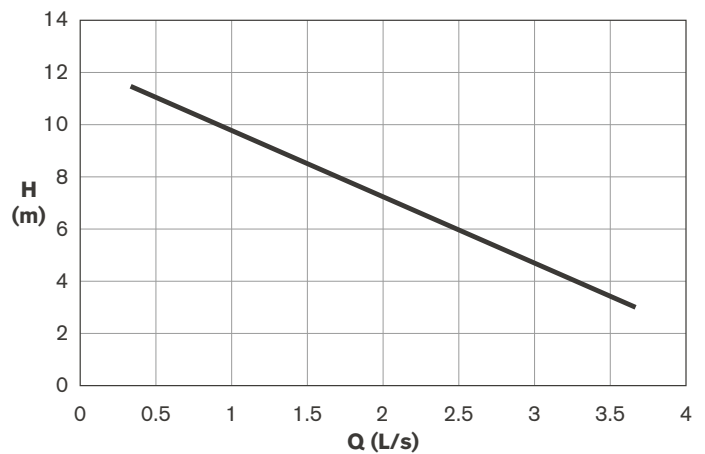

Ideal for pumping effluent, stormwater run-off and contaminated drainage water in light commercial applications, particularly where there is the likelihood of solids or stringy material.



### Dimensions (all measurements mm)

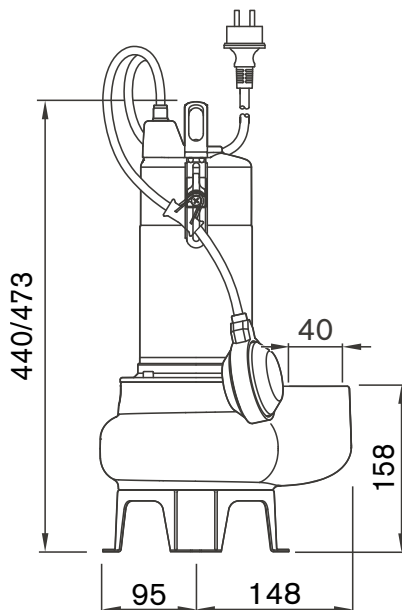

### Technical data

Model GPV	40-75	40-110
Outlet (mm)	40 BSP	
Max flow rate (L/s)	6.6	8.3
Max head (m)	10	13.5
Max liquid temp (°C)	40	
Ø Solids (mm)	40	
Power (kW)	0.75	1.1
Current (A)	4.8	6.9
Voltage (V)	240	
Speed (RPM)	2900	
Casing	Epoxy electro coated cast iron	
Impeller	Stainless vortex	
Motor housing	Stainless steel	
Protection	IP68	
Cable details	10 m length, H07RN-F	
Mounting	Free-standing only	
Weight (kg)	15.2	18.0

### Performance curve

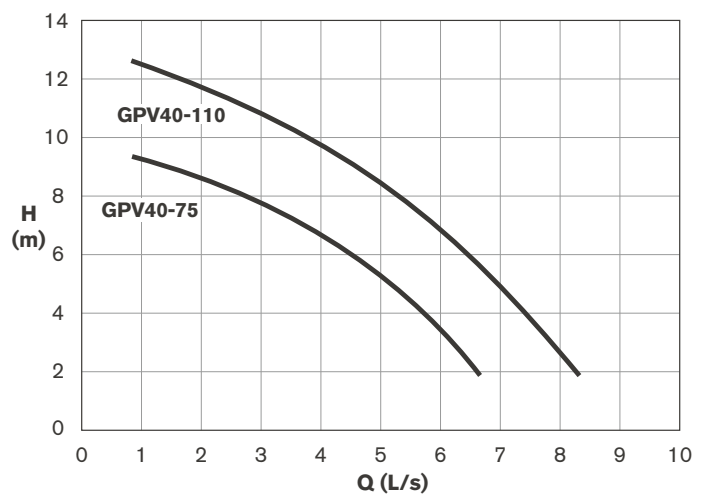

Ideal for pumping effluent, stormwater run-off and contaminated drainage water in light commercial applications, particularly where there is the likelihood of solids or stringy material.



### Technical data

Outlet (mm)	50 BSP
Max flow rate (L/s)	12.5
Max head (m)	14
Max liquid temp (°C)	40
Ø Solids (mm)	50
Power (kW)	1.1
Current (A)	7.8
Voltage (V)	240
Speed (RPM)	2900
Casing	Epoxy electro coated cast iron
Impeller	Stainless open-type
Motor housing	Stainless steel
Protection	IP68
Cable details	10 m length, H07RN-F
Mounting	Free-standing only
Weight (kg)	18.8

### Dimensions (all measurements mm)

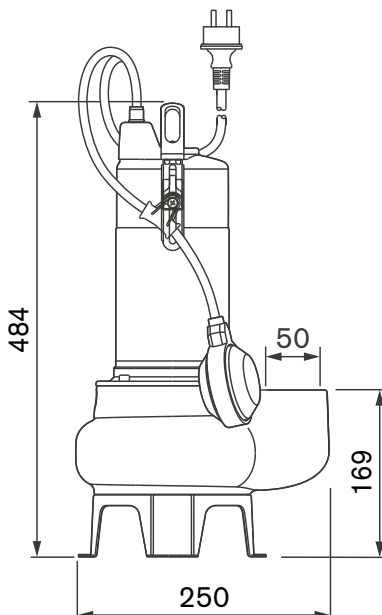

### Performance curve

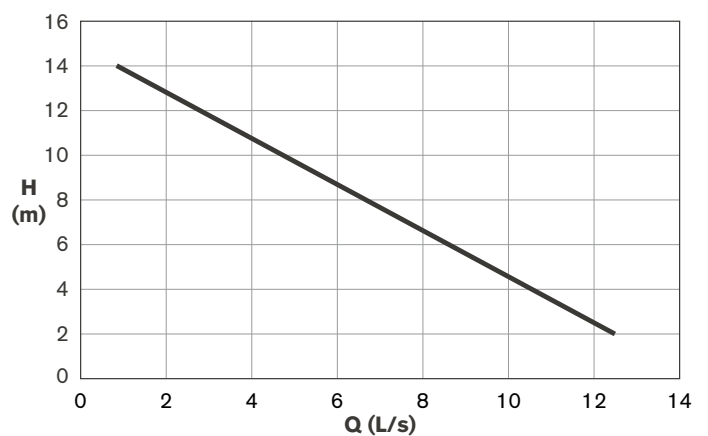

Ideal for pumping effluent, stormwater run-off and contaminated drainage water in light commercial applications, particularly where there is the likelihood of solids or stringy material.



### Technical data

Outlet (mm)	50 BSP
Max flow rate (L/s)	10.8
Max head (m)	11
Max liquid temp (°C)	40
Ø Solids (mm)	50
Power (kW)	1.1
Current (A)	6.9
Voltage (V)	240
Speed (RPM)	2900
Casing	Epoxy electro coated cast iron
Impeller	Stainless vortex
Motor housing	Stainless steel
Protection	IP68
Cable details	10 m length, H07RN-F
Mounting	Free-standing only
Weight (kg)	18.5

### Dimensions (all measurements mm)

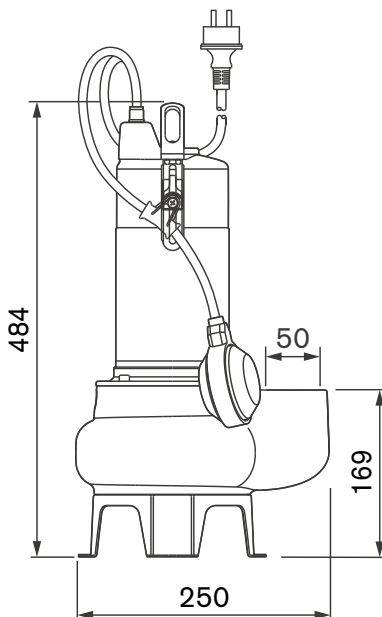

### Performance curve

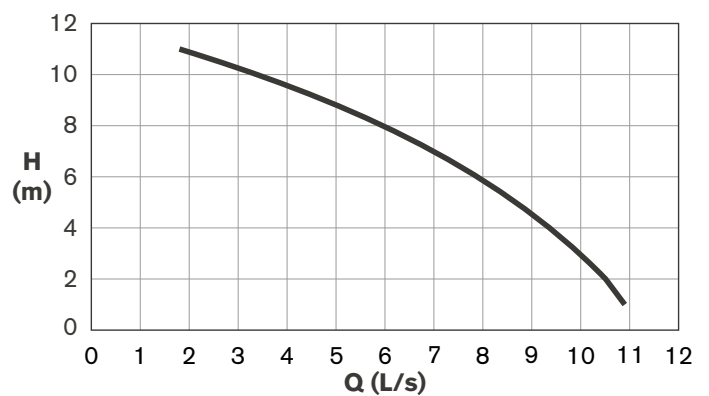

Designed for larger commercial and industrial applications, this pump is ideal for trouble-free pumping of effluent, wash-down and stormwater in commercial and industrial applications, particularly where solids and stringy material need to be handled.

Units are fitted with a powerful 1.8 kW 3-phase motor incorporating an EasyFit plug-in cable for simple disconnection and replacement.



#### Technical data

Outlet (mm)	50 BSP
Max flow rate (L/s)	9
Max head (m)	16
Max liquid temp (°C)	40
Ø Solids (mm)	40
Power (kW)	1.8
Current (A)	4.1
Voltage (V)	415
Speed (RPM)	2900
Casing	Cast iron
Impeller	Polyamide vortex
Motor housing	Stainless steel
Protection	IP68
Cable details	10 m length, H07RN8-F
Mounting	Free-standing or guide rails
Weight (kg)	20

#### Dimensions (all measurements mm)

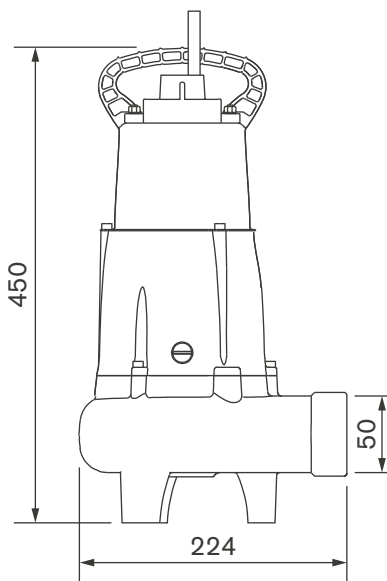

#### Performance curve

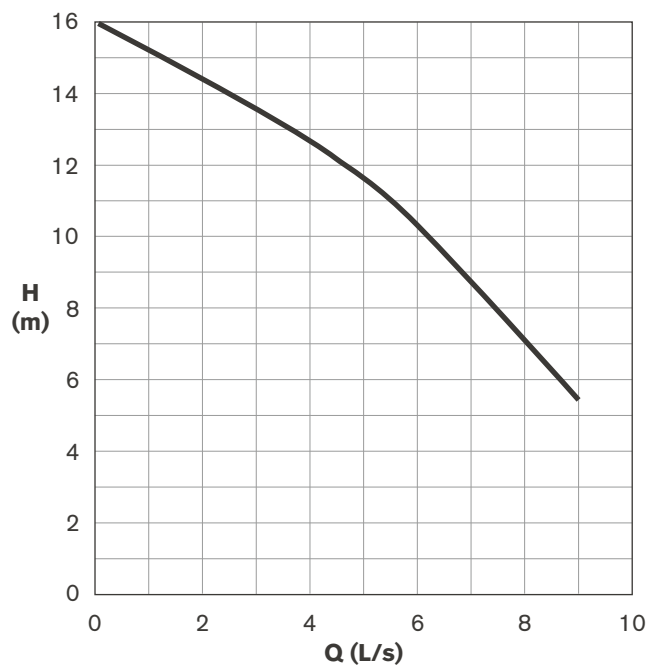



Designed for larger commercial and industrial applications, this pump is ideal for trouble-free pumping of effluent, wash-down and stormwater in commercial and industrial applications, particularly where solids and stringy material need to be handled.

Units are fitted with a powerful single-phase or 3-phase motor incorporating an EasyFit plug-in cable for simple disconnection and replacement.

GPV65-180 single-phase unit comes with an automatic float switch.



### Dimensions (all measurements mm)

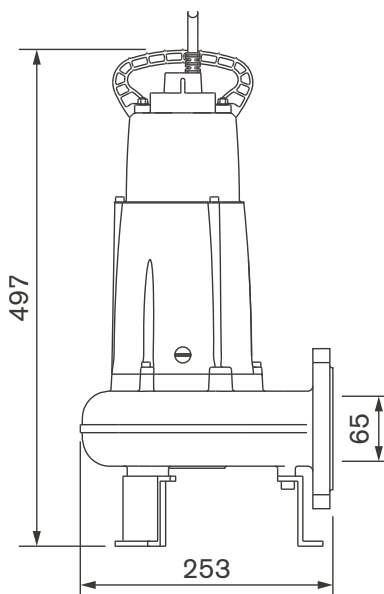

### Technical data

Model GPV	65-180	65-200
Outlet (mm)	65 DIN flange	
Max flow rate (L/s)	15.4	
Max head (m)	8.1	
Max liquid temp (°C)	40	
Ø Solids (mm)	60	
Power (kW)	1.8	2
Current (A)	11.6	4.6
Voltage (V)	240	415
Speed (RPM)	2900	
Casing	Cast iron	
Impeller	Polyamide vortex	
Motor housing	Stainless steel	
Protection	IP68	
Cable details	10 m length, H07RN8-F	
Mounting	Free-standing or guide rails	
Weight (kg)	24	

### Performance curve

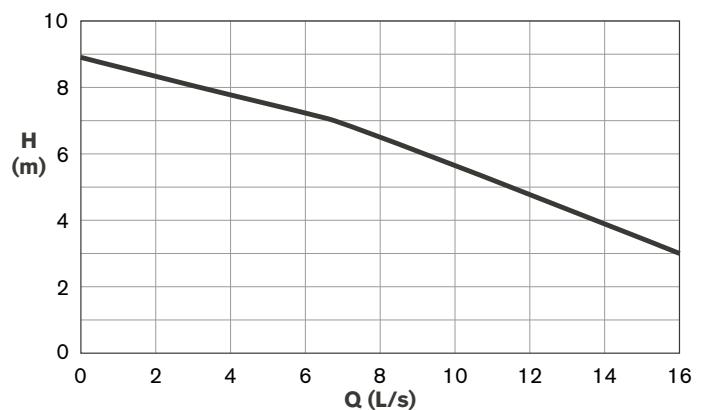

This heavy-duty range is fitted with three-phase motors and is ideal for pumping sewage, wastewater, groundwater and stormwater in locations such as blocks of flats, public buildings, factories, underground car parks and washdown areas. Units are constructed from cast iron, fitted with an open-type stainless impeller and dual oil lubricated mechanical seal.

A thermostat for over-temperature protection is fitted in the motor windings.



### Dimensions (all measurements mm)

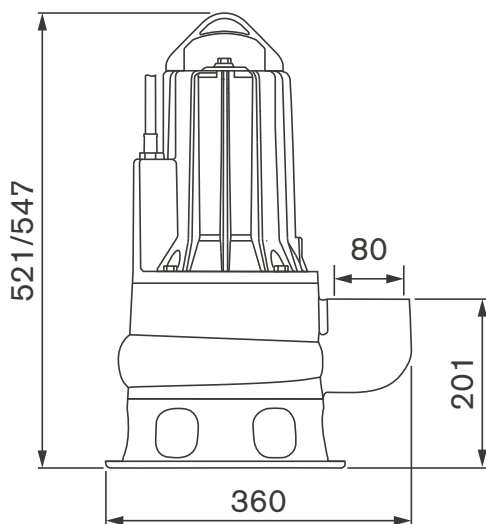

### Technical data

Model GPV	80-220	80-300
Outlet (mm)	80 BSP	
Max flow rate (L/s)	25	26.6
Max head (m)	12	15
Max liquid temp (°C)	40	
Ø Solids (mm)	65	
Power (kW)	2.2	3.0
Current (A)	6.5	7.5
Voltage (V)	415	
Speed (RPM)	2900	
Casing	Epoxy electro coated cast iron	
Impeller	Stainless open-type	
Motor housing	Epoxy electro coated cast iron	
Protection	IP68	
Cable details	10 m length, H07 RN-F	
Mounting	Free-standing only	
Weight (kg)	45	50

### Performance curve

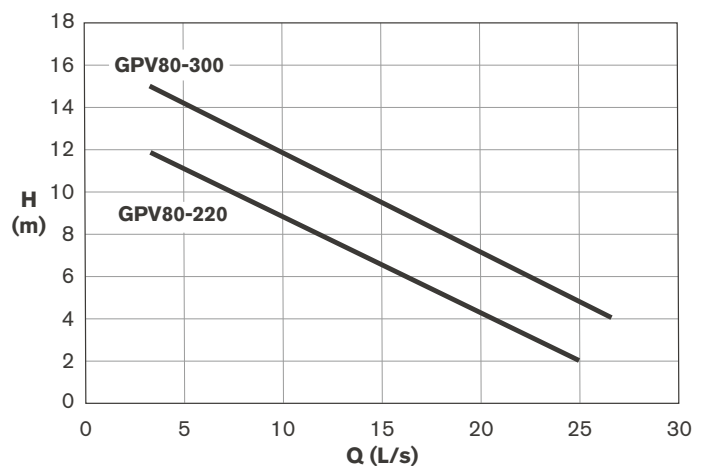

The GPVH Series Hazardous Area Submersible sump pumps are fitted with IEC Ex submersible motors suitable for use in undercroft and below ground car parks where Class 1 Zone 2 classification is required.

## Features

- Rugged cast iron housing.
- Stainless steel shaft.
- 50 mm units have double silicon carbide seals.
- Available with in-built float switch.
- Vortex impeller for full-bore solids handling.



## Dimensions (all measurements mm)

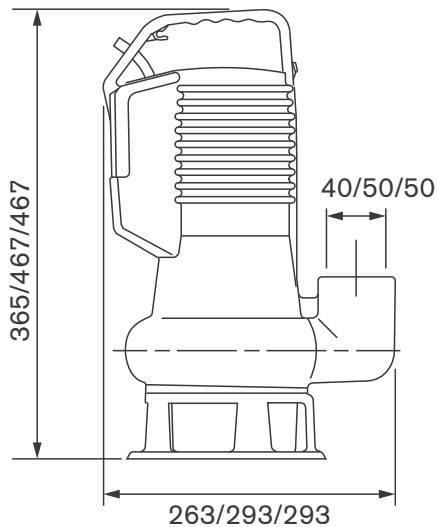

## Technical data

Model GPVH	40-75	50-110	50-150
Outlet (mm)	40 BSP	50 BSP	
Max flow rate (L/s)	7.6	10.8	12.5
Max head (m)	11.4	11.5	14.5
Max liquid temp (°C)	40		
Ø Solids (mm)	40	50	50
Power (kW)	0.75	1.1	1.5
Current (A)	5.6	7.5	10.0
Voltage (V)	240		
Speed (RPM)	2900	2780	2750
Casing	Cast iron		
Impeller	Technopolymer vortex	Cast iron vortex	
Motor housing	Cast iron		
Protection	IP68 IEC Ex		
Cable details	10 m length, 3G1		
Mounting	Free-standing or guide rails		
Weight (kg)	15.5	23	24

## Performance curve

